

C 10 15 45

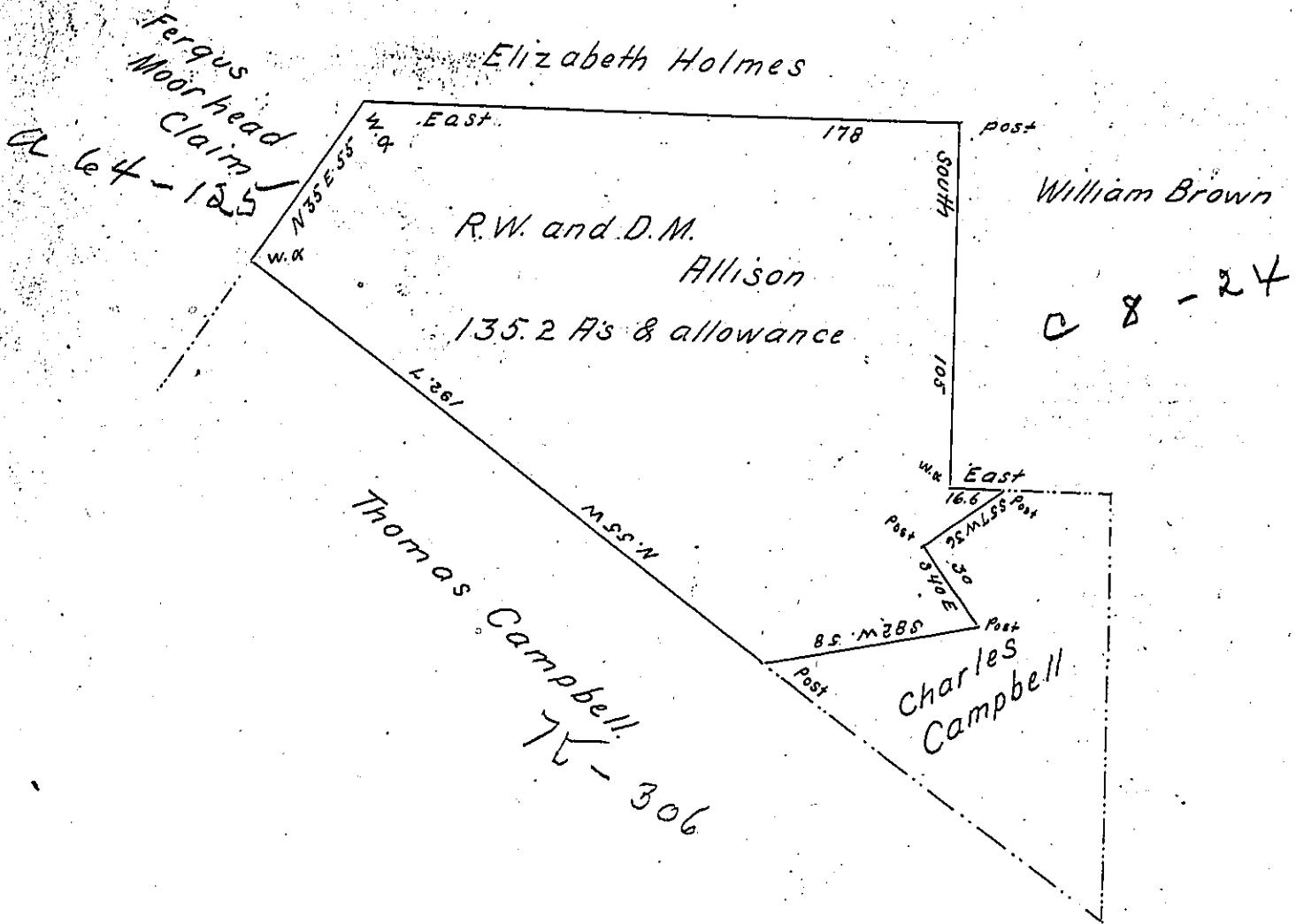

A Draft of a tract of land situated in the Township of White and County of Indiana, containing one hundred thirty five acres thirty two perches and allowance of six per cent for roads, etc. Surveyed for R.W. and D.M. Allison on the 28<sup>th</sup> day of July 1900, it being part of a larger tract containing one hundred and ninety acres forty perches and allowance, originally surveyed in pursuance of a warrant granted to Chas. Campbell dated the 7<sup>th</sup> day of June 1773.

To James W. Latta, Esq. } D.L. Moorhead  
 Secretary of Internal Affairs } County Surveyor.

Note. When this form is used the County Surveyor should indicate by dotted lines the remainder of the original survey, thus showing the location of the part returned. See paragraph nine of instructions to County Surveyors.

IN TESTIMONY that the above is a copy of the original remaining on file in the Department of Internal Affairs of Pennsylvania, made conformably to an Act of Assembly approved the 16th day of February, 1833, I have hereunto set my Hand and caused the Seal of said Department to be affixed at Harrisburg, this fourteenth day of July 1904.

*James W. Latta*  
 Secretary of Internal Affairs.